

Connection Guidelines

ST-3/XT3

Transformer-rated Wireless Site tester



ST-3/XT3 Connection Guidelines



It is essential that operators thoroughly read the User Guide before putting this product into service.

Installing the ST-3/XT3

Follow the procedure described in the *Installation of the ST-3/XT3* section of the product's User Guide.

REMINDER: Be sure to configure the removable twist tabs and set the Form Selector switch according to the meter base form you are testing.

Insert the ST-3/XT3 into the meter base and turn the device on using the ON/OFF switch.



PROBEWELL
CONNECT
2.0

Download



Windows version

www.probewell.com/pw-connect

Connecting to the ST-3/XT3 with a mobile device



- 1 To connect, open the **Probewell Connect 2.0** application on your mobile device.
- 2 Scan the QR code on the device for first use.



Manual network connection: If a connection can't be established, tap the Manual Network Connection button and follow the on-screen instructions.

Connecting to the ST-3/XT3 from a computer



- 1 To connect, go to *Windows Settings*, Select *Network & Internet*.



The Network icon often located on the bottom right of your screen, is a shortcut.



- A. Locate the socket SSID in the list of available networks.
 - B. When connecting to a socket's network for the first time, input the SSID name as the security key. (i.e., **PW-XT3-{Your Serial Number}-AP**).
- 2 Open the **Probewell Connect 2.0 for Windows** on your computer.

Note: Once the connection process has been completed, the socket's SSID will appear on the network list in future sessions.

The device only allows one user to connect at a time.

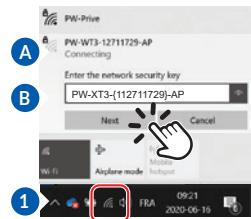

* Probewell Lab Inc. cannot control nor be held responsible for compatibility issues resulting from mobile phone manufacturers' non-compliance with current firmware and/or operating system standards.

Version 1.3



1-866-626-1126
support@probewell.com

www.probewell.com